

REECE, K ERIC  
156 ACADEMY RD  
BOWDOIN ME 04287

B3187P165 B3283P158

Inspection Witnessed By:

No./Date	Description	Date Insp.
X		

Notes:

**Bowdoin**

Property Data			Assessment Record						
Neighborhood <b>15 Map 15</b>			Year	Land	Buildings	Exempt	Total		
Tree Growth Year <b>0</b>			2009	60,510	198,880	10,000	249,390		
Farmland Yr <b>0</b>			2010	60,510	198,880	10,000	249,390		
Open Space Yr <b>0</b>			2011	60,510	198,880	10,000	249,390		
Zone/Land Use <b>11 Residential 1</b>			2012	60,510	198,880	10,000	249,390		
Secondary Zone			2013	60,510	198,880	10,000	249,390		
Topography			2014	60,510	198,880	10,000	249,390		
1.Level 4.Below St 7.LevelBog			2015	60,510	198,880	10,000	249,390		
2.Rolling 5.Low 8.Conform			2016	60,510	198,880	15,000	244,390		
3.Above St 6.FZone 9.Non-Confor			2017	60,510	198,880	20,000	239,390		
Utilities			2018	60,510	198,880	20,000	239,390		
1.Public 4.Dr Well 7.Cesspool			2019	60,510	198,880	20,000	239,390		
2.Water 5.Dug Well 8.			2020	60,510	198,880	25,000	234,390		
3.Sewer 6.Septic 9.None			2021	60,510	198,880	25,000	234,390		
Street <b>1 Paved</b>			2022	60,510	190,170	21,500	229,180		
1.Paved 4.Proposed 7.MHG			<b>Land Data</b>						
2.Semi Imp 5.R/O/W 8.DIS									
3.Gravel 6.MHP 9.None			<b>Front Foot</b>	<b>Type</b>	<b>Effective</b>		<b>Influence</b>		<b>Influence Codes</b>
TG PLAN YEAR <b>0</b>			11.Road Frontage		<b>Frontage</b>	<b>Depth</b>	<b>Factor</b>	<b>Code</b>	
Tif District # <b>0</b>			12.Delta Triangle						1.Unimproved
<b>Sale Data</b>			13.Nabla Triangle						2.Excess Frtg
Sale Date <b>3/31/2011</b>			14.Rear Land						3.Topography
Price <b>43,444</b>			15.Miscellaneous						4.Size/Shape
Sale Type <b>2 Land &amp; Buildings</b>									5.Access
1.Land 4.Mobile 7.C/I L&B			<b>Square Foot</b>	<b>Square Feet</b>					6.Restriction
2.L & B 5.Other 8.			16.Regular Lot						7.Open Space
3.Building 6.C/I Land 9.			17.Secondary Lot						8.View/Environ
Financing <b>9 Unknown</b>			18.Hydro Facility						9.Fract Share
1.Convent 4.Seller 7.			19.Improvements						<b>Acres</b>
2.FHA/VA 5.Private 8.			20.Base 3 (Fract)						30.Rear Land 3
3.Assumed 6.Cash 9.Unknown									31.Tillable
Validity <b>3 Distressed Sale</b>			<b>Fract. Acre</b>	<b>Acres/Sites</b>					32.Pasture
1.Valid 4.Split 7.Renovate			21.Base 1 (Fract)	24	1.00	100	%	0	33.Orchard
2.Related 5.Partial 8.Other			22.Base 2 (Fract)	28	9.29	100	%	0	34.Softwood F&O
3.Distress 6.Exempt 9.Short			23.Base 3	44	1.00	100	%	0	35.Mixed Wood F&O
Verified <b>5 Public Record</b>			<b>Acres</b>	52	314.23	100	%	0	36.Hardwood F&O
1.Buyer 4.Agent 7.Family			24.Base 1						37.Softwood TG
2.Seller 5.Pub Rec 8.Other			25.Base 2						38.Mixed Wood TG
3.Lender 6.MLS 9.			26.Frontage 1						39.Hardwood TG
			27.Rear Land 4						40.Wasteland
			28.Rear Land 1						41.Commercial
			29.Rear Land 2						42.2nd Site
			<b>Total Acreage</b>		10.29				43.Post Rd
									44.Lot Improvemen
									45.Subdivision Lo
									46.Golf Course

**Bowdoin**

Map Lot 15-06-01

Account 1454

Location 156 ACADEMY RD

Card 1 Of 1 7/22/2022

Building Style <b>7 Contemporary</b>	SF Bsmt Living <b>0</b>	Layout <b>1 Typical</b>
0.Not Code 4.Cape 8.Log	Fin Bsmt Grade <b>0 0</b>	1.Typical 4. 7.
1.Conv. 5.Garrison 9.Other	OCCUPANCY <b>0</b>	2.Inadeq 5. 8.
2.Ranch 6.Split 10.DW	Heat Type <b>100% 5 Forced Warm Air</b>	3.Poor 6. 9.
3.R Ranch 7.Contemp 11.Church	0.Not Code 4.Steam 8.F/Wall	Attic <b>9 None</b>
Dwelling Units <b>1</b>	1.HWBB 5.FWA 9.No Heat	1.1/4 Fin 4.Full Fin 7.
Other Units <b>0</b>	2.HWCI 6.GravWA 11.	2.1/2 Fin 5.F/Stair 8.
Stories <b>2 Two Story</b>	3.H Pump 7.Electric 12.	3.3/4 Fin 6. 9.None
1.1 4.1.5 7.4	Cool Type <b>0% 9 None</b>	Insulation <b>1 Full</b>
2.2 5.1.75 8.20	1.Refrig 4.W&C Air 7.	1.Full 4.Minimal 7.
3.3 6.2.5 9.Yurt	2.Evapor 5. 8.	2.Heavy 5. 8.
Exterior Walls <b>2 Vinyl/Aluminum</b>	3.H Pump 6. 9.None	3.Capped 6. 9.None
0.Not Code 4.Asbestos 8.Concrete	Kitchen Style <b>2 Typical</b>	Unfinished % <b>0%</b>
1.Wood 5.Stucco 9.Other	1.Modern 4.Obsolete 7.	Grade & Factor <b>3 Average 110%</b>
2.Vin/Al 6.Brick 10.Board B	2.Typical 5. 8.	1.E Grade 4.B Grade 7.
3.Compos. 7.Stone 12.	3.Old Type 6. 9.None	2.D Grade 5.A Grade 8.
Roof Surface <b>1 Asphalt Shingles</b>	Bath(s) Style <b>2 Typical Bath(s)</b>	3.C Grade 6.AA Grade 9.Same
1.Asphalt 4.Composit 7.	1.Modern 4.Obsolete 7.	SQFT (Footprint) <b>1008</b>
2.Slate 5.Wood 8.	2.Typical 5. 8.	Condition <b>4 Average</b>
3.Metal 6.Other 9.	3.Old Type 6. 9.None	1.Poor 4.Avg 7.V G
SF Masonry Trim <b>0</b>	# Rooms <b>8</b>	2.Fair 5.Avg+ 8.Exc
SEPTIC DESIGN <b>0</b>	# Bedrooms <b>3</b>	3.Avg- 6.Good 9.Same
BLDG PERMIT <b>0</b>	# Full Baths <b>1</b>	Phys. % Good <b>0%</b>
Year Built <b>1999</b>	# Half Baths <b>1</b>	Funct. % Good <b>100%</b>
Year Remodeled <b>0</b>	# Addn Fixtures <b>0</b>	Functional Code <b>9 None</b>
Foundation <b>1 Concrete</b>	# Fireplaces <b>0</b>	1.Incomp 4.Delap 7.No Power
1.Concrete 4.Wood 7.	 <p><b>TRIO</b> Software A Division of Harris Computer Systems</p>	2.O-Built 5.Bsmt 8.LongTerm
2.C Block 5.Slab 8.		3.Damage 6.Dbwd 9.None
3.Br/Stone 6.Piers 9.		Econ. % Good <b>100%</b>
Basement <b>4 Full Basement</b>		Economic Code <b>None</b>
1.1/4 Bmt 4.Full Bmt 7.		0.None 3.No Power 7.
2.1/2 Bmt 5.None 8.		1.Location 4.Generate 8.
3.3/4 Bmt 6. 9.None		2.Encroach 9.None 9.
Bsmt Gar # Cars <b>0</b>		Entrance Code <b>5 Estimated</b>
Wet Basement <b>0</b>		1.Interior 4.Vacant 7.Entered
1.Dry 4. 7.		2.Refusal 5.Estimate 8.No
2.Damp 5. 8.	3.Informed 6.Reviewed 9.Land	
3.Wet 6. 9.	Information Code <b>5 Estimate</b>	
	1.Owner 4.Agent 7.	
	2.Relative 5.Estimate 8.	
	3.Tenant 6.Other 9.	

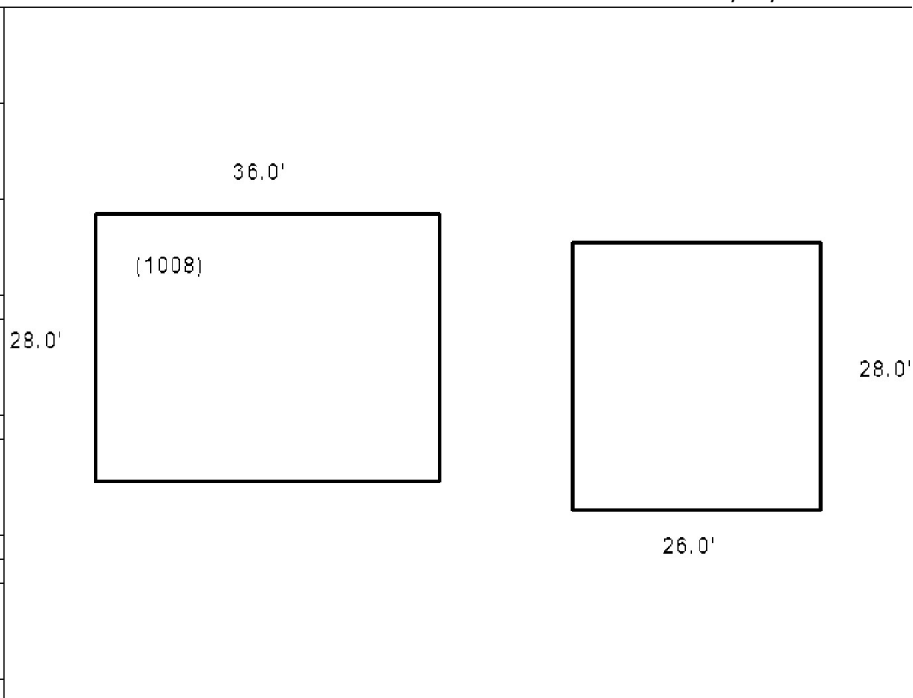

Date Inspected 3/15/2004

**Additions, Outbuildings & Improvements**

Type	Year	Units	Grade	Cond	Phys.	Funct.	Sound Value
30 Detached Garage	2003	728	3 100	4	0 %	100 %	
49 Storage space	2993	364	3 100	4	0 %	100 %	
					%	%	
					%	%	
					%	%	
					%	%	
					%	%	
					%	%	
					%	%	
					%	%	
					%	%	



- 1.One Story Fram
- 2.Two Story Fram
- 3.Three Story Fr
- 4.1 & 1/2 Story
- 5.1 & 3/4 Story
- 6.2 & 1/2 Story
- 21.Open Frame Por
- 22.Encl Frame Por
- 23.Attached Garag
- 24.Frame Shed
- 25.Frame Bay Wind
- 26.1SFr Overhang
- 27.Unfin Basement
- 28.Unfinished Att
- 29.Finished Attic

MARQUIS, STEVEN E  
MARQUIS, DEBORAH M  
148 ACADEMY RD  
BOWDOIN ME 04287

B1771P134 B3306P15

Previous Owner  
HARVEY, ELROY T  
HARVEY, RINA M  
148 ACADEMY RD  
BOWDOIN ME 04287  
Sale Date: 7/22/2011

Inspection Witnessed By:

X Date

No./Date	Description	Date Insp.

Notes:

**Bowdoin**

Property Data			Assessment Record						
Neighborhood <b>15 Map 15</b>			Year	Land	Buildings	Exempt	Total		
Tree Growth Year <b>0</b>			2009	59,690	252,540	16,000	296,230		
Farmland Yr <b>0</b>			2010	59,690	252,540	16,000	296,230		
Open Space Yr <b>0</b>			2011	59,690	252,540	16,000	296,230		
Zone/Land Use <b>11 Residential 1</b>			2012	59,690	252,540	10,000	302,230		
Secondary Zone			2013	59,690	252,540	10,000	302,230		
Topography			2014	59,690	252,540	10,000	302,230		
1.Level 4.Below St 7.LevelBog			2015	59,690	252,540	10,000	302,230		
2.Rolling 5.Low 8.Conform			2016	59,690	255,630	15,000	300,320		
3.Above St 6.FZone 9.Non-Confor			2017	59,690	255,630	20,000	295,320		
Utilities			2018	59,690	255,630	20,000	295,320		
1.Public 4.Dr Well 7.Cesspool			2019	59,690	255,630	20,000	295,320		
2.Water 5.Dug Well 8.			2020	59,690	211,760	25,000	246,450		
3.Sewer 6.Septic 9.None			2021	59,690	211,760	25,000	246,450		
Street <b>1 Paved</b>			2022	59,690	202,550	21,500	240,740		
1.Paved 4.Proposed 7.MHG			<b>Land Data</b>						
2.Semi Imp 5.R/O/W 8.DIS									
3.Gravel 6.MHP 9.None			<b>Front Foot</b>	<b>Type</b>	<b>Effective</b>		<b>Influence</b>		<b>Influence Codes</b>
TG PLAN YEAR <b>0</b>			11.Road Frontage		<b>Frontage</b>	<b>Depth</b>	<b>Factor</b>	<b>Code</b>	
Tif District # <b>0</b>			12.Delta Triangle				%		1.Unimproved
<b>Sale Data</b>			13.Nabla Triangle				%		2.Excess Frtg
Sale Date <b>7/22/2011</b>			14.Rear Land				%		3.Topography
Price <b>262,500</b>			15.Miscellaneous				%		4.Size/Shape
Sale Type <b>2 Land &amp; Buildings</b>							%		5.Access
1.Land 4.Mobile 7.C/I L&B							%		6.Restriction
2.L & B 5.Other 8.			<b>Square Foot</b>	<b>Square Feet</b>					7.Open Space
3.Building 6.C/I Land 9.			16.Regular Lot				%		8.View/Environ
Financing <b>9 Unknown</b>			17.Secondary Lot				%		9.Fract Share
1.Convent 4.Seller 7.			18.Hydro Facility				%		<b>Acres</b>
2.FHA/VA 5.Private 8.			19.Improvements				%		30.Rear Land 3
3.Assumed 6.Cash 9.Unknown			20.Base 3 (Fract)				%		31.Tillable
Validity <b>1 Arms Length Sale</b>							%		32.Pasture
1.Valid 4.Split 7.Renovate			<b>Fract. Acre</b>	<b>Acres/Sites</b>					33.Orchard
2.Related 5.Partial 8.Other			21.Base 1 (Fract)	24	1.00	100	%	0	34.Softwood F&O
3.Distress 6.Exempt 9.Short			22.Base 2 (Fract)	28	8.71	100	%	0	35.Mixed Wood F&O
Verified <b>5 Public Record</b>			23.Base 3	44	1.00	100	%	0	36.Hardwood F&O
1.Buyer 4.Agent 7.Family			<b>Acres</b>	52	308.57	100	%	0	37.Softwood TG
2.Seller 5.Pub Rec 8.Other			24.Base 1				%		38.Mixed Wood TG
3.Lender 6.MLS 9.			25.Base 2				%		39.Hardwood TG
			26.Frontage 1				%		40.Wasteland
			27.Rear Land 4				%		41.Commercial
			28.Rear Land 1				%		42.2nd Site
			29.Rear Land 2				%		43.Post Rd
			<b>Total Acreage</b>		9.71				44.Lot Improvemen
									45.Subdivision Lo
									46.Golf Course





**Bowdoin**

Map Lot 15-06-03

Account 1456

Location ACADEMY RD

Card 1 Of 1 7/22/2022

Building Style <b>0 Not Coded</b>	SF Bsmt Living <b>0</b>	Layout <b>0</b>
0.Not Code 4.Cape 8.Log	Fin Bsmt Grade <b>0 0</b>	1.Typical 4. 7.
1.Conv. 5.Garrison 9.Other	OCCUPANCY <b>0</b>	2.Inadeq 5. 8.
2.Ranch 6.Split 10.DW	Heat Type <b>100% 0 Not Coded</b>	3.Poor 6. 9.
3.R Ranch 7.Contemp 11.Church	0.Not Code 4.Steam 8.FI/Wall	Attic <b>0</b>
Dwelling Units <b>0</b>	1.HWBB 5.FWA 9.No Heat	1.1/4 Fin 4.Full Fin 7.
Other Units <b>0</b>	2.HWCI 6.GravWA 11.	2.1/2 Fin 5.FI/Stair 8.
Stories <b>0</b>	3.H Pump 7.Electric 12.	3.3/4 Fin 6. 9.None
1.1 4.1.5 7.4	Cool Type <b>0% 9 None</b>	Insulation <b>0</b>
2.2 5.1.75 8.20	1.Refrig 4.W&C Air 7.	1.Full 4.Minimal 7.
3.3 6.2.5 9.Yurt	2.Evapor 5. 8.	2.Heavy 5. 8.
Exterior Walls <b>0 Not Coded</b>	3.H Pump 6. 9.None	3.Capped 6. 9.None
0.Not Code 4.Asbestos 8.Concrete	Kitchen Style <b>0</b>	Unfinished % <b>0%</b>
1.Wood 5.Stucco 9.Other	1.Modern 4.Obsolete 7.	Grade & Factor <b>0 0%</b>
2.Vin/Al 6.Brick 10.Board B	2.Typical 5. 8.	1.E Grade 4.B Grade 7.
3.Compos. 7.Stone 12.	3.Old Type 6. 9.None	2.D Grade 5.A Grade 8.
Roof Surface <b>0</b>	Bath(s) Style <b>0</b>	3.C Grade 6.AA Grade 9.Same
1.Asphalt 4.Composit 7.	1.Modern 4.Obsolete 7.	SQFT (Footprint) <b>0</b>
2.Slate 5.Wood 8.	2.Typical 5. 8.	Condition <b>0</b>
3.Metal 6.Other 9.	3.Old Type 6. 9.None	1.Poor 4.Avg 7.V G
SF Masonry Trim <b>0</b>	# Rooms <b>0</b>	2.Fair 5.Avg+ 8.Exc
SEPTIC DESIGN <b>0</b>	# Bedrooms <b>0</b>	3.Avg- 6.Good 9.Same
BLDG PERMIT <b>0</b>	# Full Baths <b>0</b>	Phys. % Good <b>0%</b>
Year Built <b>0</b>	# Half Baths <b>0</b>	Funct. % Good <b>100%</b>
Year Remodeled <b>0</b>	# Addn Fixtures <b>0</b>	Functional Code <b>9 None</b>
Foundation <b>0</b>	# Fireplaces <b>0</b>	1.Incomp 4.Delap 7.No Power
1.Concrete 4.Wood 7.		2.O-Built 5.Bsmt 8.LongTerm
2.C Block 5.Slab 8.		3.Damage 6.Dbwd 9.None
3.Br/Stone 6.Piers 9.		Econ. % Good <b>100%</b>
Basement <b>0</b>		Economic Code <b>None</b>
1.1/4 Bmt 4.Full Bmt 7.		0.None 3.No Power 7.
2.1/2 Bmt 5.None 8.		1.Location 4.Generate 8.
3.3/4 Bmt 6. 9.None		2.Encroach 9.None 9.
Bsmt Gar # Cars <b>0</b>		Entrance Code <b>0</b>
Wet Basement <b>0</b>		1.Interior 4.Vacant 7.Entered
1.Dry 4. 7.		2.Refusal 5.Estimate 8.No
2.Damp 5. 8.		3.Informed 6.Reviewed 9.Land
3.Wet 6. 9.		Information Code <b>0</b>
		1.Owner 4.Agent 7.
		2.Relative 5.Estimate 8.
		3.Tenant 6.Other 9.



Date Inspected

Additions, Outbuildings & Improvements							
Type	Year	Units	Grade	Cond	Phys.	Funct.	Sound Value
					%	%	1.One Story Fram
					%	%	2.Two Story Fram
					%	%	3.Three Story Fr
					%	%	4.1 & 1/2 Story
					%	%	5.1 & 3/4 Story
					%	%	6.2 & 1/2 Story
					%	%	21.Open Frame Por
					%	%	22.Encl Frame Por
					%	%	23.Attached Garag
					%	%	24.Frame Shed
					%	%	25.Frame Bay Wind
					%	%	26.1SFr Overhang
					%	%	27.Unfin Basement
					%	%	28.Unfinished Att
					%	%	29.Finished Attic



**Bowdoin**

Map Lot 15-07-0

Account 1457

Location 260 ACADEMY RD

Card 1 Of 1 7/22/2022

Building Style <b>0 Not Coded</b>	SF Bsmt Living <b>0</b>	Layout <b>0</b>
0.Not Code 4.Cape 8.Log	Fin Bsmt Grade <b>0 0</b>	1.Typical 4. 7.
1.Conv. 5.Garrison 9.Other	OCCUPANCY <b>0</b>	2.Inadeq 5. 8.
2.Ranch 6.Split 10.DW	Heat Type <b>100% 0 Not Coded</b>	3.Poor 6. 9.
3.R Ranch 7.Contemp 11.Church	0.Not Code 4.Steam 8.FI/Wall	Attic <b>0</b>
Dwelling Units <b>0</b>	1.HWBB 5.FWA 9.No Heat	1.1/4 Fin 4.Full Fin 7.
Other Units <b>0</b>	2.HWCI 6.GravWA 11.	2.1/2 Fin 5.FI/Stair 8.
Stories <b>0</b>	3.H Pump 7.Electric 12.	3.3/4 Fin 6. 9.None
1.1 4.1.5 7.4	Cool Type <b>0% 9 None</b>	Insulation <b>0</b>
2.2 5.1.75 8.20	1.Refrig 4.W&C Air 7.	1.Full 4.Minimal 7.
3.3 6.2.5 9.Yurt	2.Evapor 5. 8.	2.Heavy 5. 8.
Exterior Walls <b>0 Not Coded</b>	3.H Pump 6. 9.None	3.Capped 6. 9.None
0.Not Code 4.Asbestos 8.Concrete	Kitchen Style <b>0</b>	Unfinished % <b>0%</b>
1.Wood 5.Stucco 9.Other	1.Modern 4.Obsolete 7.	Grade & Factor <b>0 0%</b>
2.Vin/Al 6.Brick 10.Board B	2.Typical 5. 8.	1.E Grade 4.B Grade 7.
3.Compos. 7.Stone 12.	3.Old Type 6. 9.None	2.D Grade 5.A Grade 8.
Roof Surface <b>0</b>	Bath(s) Style <b>0</b>	3.C Grade 6.AA Grade 9.Same
1.Asphalt 4.Composit 7.	1.Modern 4.Obsolete 7.	SQFT (Footprint) <b>0</b>
2.Slate 5.Wood 8.	2.Typical 5. 8.	Condition <b>0</b>
3.Metal 6.Other 9.	3.Old Type 6. 9.None	1.Poor 4.Avg 7.V G
SF Masonry Trim <b>0</b>	# Rooms <b>0</b>	2.Fair 5.Avg+ 8.Exc
SEPTIC DESIGN <b>0</b>	# Bedrooms <b>0</b>	3.Avg- 6.Good 9.Same
BLDG PERMIT <b>0</b>	# Full Baths <b>0</b>	Phys. % Good <b>0%</b>
Year Built <b>0</b>	# Half Baths <b>0</b>	Funct. % Good <b>100%</b>
Year Remodeled <b>0</b>	# Addn Fixtures <b>0</b>	Functional Code <b>9 None</b>
Foundation <b>0</b>	# Fireplaces <b>0</b>	1.Incomp 4.Delap 7.No Power
1.Concrete 4.Wood 7.		2.O-Built 5.Bsmt 8.LongTerm
2.C Block 5.Slab 8.		3.Damage 6.Dbwd 9.None
3.Br/Stone 6.Piers 9.		Econ. % Good <b>100%</b>
Basement <b>0</b>		Economic Code <b>None</b>
1.1/4 Bmt 4.Full Bmt 7.		0.None 3.No Power 7.
2.1/2 Bmt 5.None 8.		1.Location 4.Generate 8.
3.3/4 Bmt 6. 9.None		2.Encroach 9.None 9.
Bsmt Gar # Cars <b>0</b>		Entrance Code <b>0</b>
Wet Basement <b>0</b>		1.Interior 4.Vacant 7.Entered
1.Dry 4. 7.		2.Refusal 5.Estimate 8.No
2.Damp 5. 8.		3.Informed 6.Reviewed 9.Land
3.Wet 6. 9.		Information Code <b>0</b>
		1.Owner 4.Agent 7.
		2.Relative 5.Estimate 8.
		3.Tenant 6.Other 9.

Date Inspected 5/04/2021

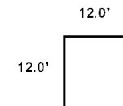
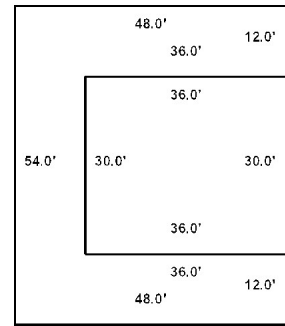

Additions, Outbuildings & Improvements							
Type	Year	Units	Grade	Cond	Phys.	Funct.	Sound Value
70 Shed Roof	2020	384	3 100	4	0 %	100 %	
70 Shed Roof	2020	1512	3 100	4	0 %	100 %	
24 Frame Shed	1997	144	2 110	4	0 %	100 %	
90 1S Garage	2020	1080	3 100	4	0 %	100 %	
57 Living Space over	2020	1080	3 100	4	0 %	100 %	
85 Bathroom 3Pc	2020	1	3 100	4	0 %	100 %	
					%	%	
					%	%	
					%	%	
					%	%	







**Bowdoin**

Map Lot 15-09-0

Account 1459

Location 1288 LITCHFIELD RD

Card 1 Of 1 7/22/2022

Building Style <b>4 Cape Cod</b>	SF Bsmt Living <b>0</b>	Layout <b>1 Typical</b>
0.Not Code 4.Cape 8.Log	Fin Bsmt Grade <b>0 0</b>	1.Typical 4. 7.
1.Conv. 5.Garrison 9.Other	OCCUPANCY <b>0</b>	2.Inadeq 5. 8.
2.Ranch 6.Split 10.DW	Heat Type <b>100% 1 Hot Water BB</b>	3.Poor 6. 9.
3.R Ranch 7.Contemp 11.Church	0.Not Code 4.Steam 8.FI/Wall	Attic <b>9 None</b>
Dwelling Units <b>1</b>	1.HWBB 5.FWA 9.No Heat	1.1/4 Fin 4.Full Fin 7.
Other Units <b>0</b>	2.HWCI 6.GravWA 11.	2.1/2 Fin 5.FI/Stair 8.
Stories <b>2 Two Story</b>	3.H Pump 7.Electric 12.	3.3/4 Fin 6. 9.None
1.1 4.1.5 7.4	Cool Type <b>0% 9 None</b>	Insulation <b>1 Full</b>
2.2 5.1.75 8.20	1.Refrig 4.W&C Air 7.	1.Full 4.Minimal 7.
3.3 6.2.5 9.Yurt	2.Evapor 5. 8.	2.Heavy 5. 8.
Exterior Walls <b>2 Vinyl/Aluminum</b>	3.H Pump 6. 9.None	3.Capped 6. 9.None
0.Not Code 4.Asbestos 8.Concrete	Kitchen Style <b>2 Typical</b>	Unfinished % <b>0%</b>
1.Wood 5.Stucco 9.Other	1.Modern 4.Obsolete 7.	Grade & Factor <b>3 Average 100%</b>
2.Vin/Al 6.Brick 10.Board B	2.Typical 5. 8.	1.E Grade 4.B Grade 7.
3.Compos. 7.Stone 12.	3.Old Type 6. 9.None	2.D Grade 5.A Grade 8.
Roof Surface <b>1 Asphalt Shingles</b>	Bath(s) Style <b>2 Typical Bath(s)</b>	3.C Grade 6.AA Grade 9.Same
1.Asphalt 4.Composit 7.	1.Modern 4.Obsolete 7.	SQFT (Footprint) <b>1024</b>
2.Slate 5.Wood 8.	2.Typical 5. 8.	Condition <b>3 Below Average</b>
3.Metal 6.Other 9.	3.Old Type 6. 9.None	1.Poor 4.Avg 7.V G
SF Masonry Trim <b>0</b>	# Rooms <b>9</b>	2.Fair 5.Avg+ 8.Exc
SEPTIC DESIGN <b>0</b>	# Bedrooms <b>4</b>	3.Avg- 6.Good 9.Same
BLDG PERMIT <b>0</b>	# Full Baths <b>1</b>	Phys. % Good <b>0%</b>
Year Built <b>1950</b>	# Half Baths <b>1</b>	Funct. % Good <b>100%</b>
Year Remodeled <b>0</b>	# Addn Fixtures <b>0</b>	Functional Code <b>9 None</b>
Foundation <b>1 Concrete</b>	# Fireplaces <b>0</b>	1.Incomp 4.Delap 7.No Power
1.Concrete 4.Wood 7.	 <p><b>TRIO</b> Software A Division of Harris Computer Systems</p>	2.O-Built 5.Bsmt 8.LongTerm
2.C Block 5.Slab 8.		3.Damage 6.Dbwd 9.None
3.Br/Stone 6.Piers 9.		Econ. % Good <b>100%</b>
Basement <b>4 Full Basement</b>		Economic Code <b>None</b>
1.1/4 Bmt 4.Full Bmt 7.		0.None 3.No Power 7.
2.1/2 Bmt 5.None 8.		1.Location 4.Generate 8.
3.3/4 Bmt 6. 9.None		2.Encroach 9.None 9.
Bsmt Gar # Cars <b>0</b>		Entrance Code <b>3 Information Only</b>
Wet Basement <b>0</b>		1.Interior 4.Vacant 7.Entered
1.Dry 4. 7.		2.Refusal 5.Estimate 8.No
2.Damp 5. 8.	3.Informed 6.Reviewed 9.Land	
3.Wet 6. 9.	Information Code <b>1 Owner</b>	
	1.Owner 4.Agent 7.	
	2.Relative 5.Estimate 8.	
	3.Tenant 6.Other 9.	

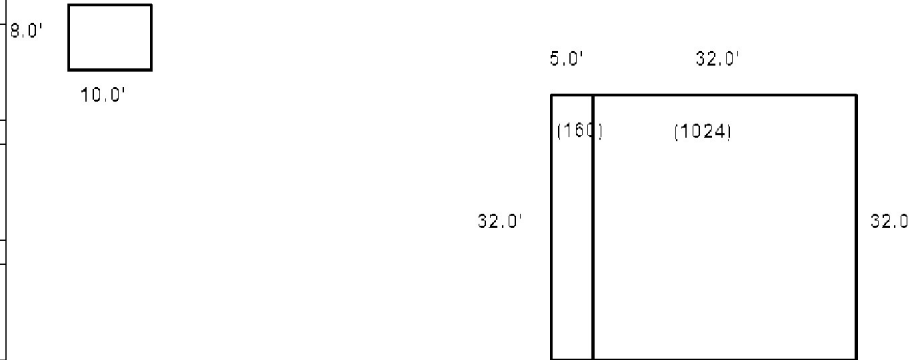

Date Inspected

**Additions, Outbuildings & Improvements**

Type	Year	Units	Grade	Cond	Phys.	Funct.	Sound Value
21 Open Frame	0	160	0 0	0	0 %	0 %	
24 Frame Shed	0				%	%	500
					%	%	
					%	%	
					%	%	
					%	%	
					%	%	
					%	%	
					%	%	
					%	%	
					%	%	



COTE, JASON R  
404 RICHMOND ROAD  
LITCHFIELD ME 04350

B2524P112 B2020RP8345

Previous Owner  
SHAY, JALAUREN  
1252 LITCHFIELD RD

BOWDOIN ME 04287  
Sale Date: 10/20/2020

Previous Owner  
BARTER, DALE & JILL M  
1252 LITCHFIELD RD

BOWDOIN ME 04287  
Sale Date: 2/09/2005

Inspection Witnessed By:

X	Date
No./Date	Description
	Date Insp.

Notes:

**Bowdoin**

Property Data			Assessment Record						
Neighborhood <b>15 Map 15</b>			Year	Land	Buildings	Exempt	Total		
Tree Growth Year <b>0</b>			2009	73,380	158,030	10,000	221,410		
Farmland Yr <b>0</b>			2010	73,380	116,320	10,000	179,700		
Open Space Yr <b>0</b>			2011	73,380	116,320	10,000	179,700		
Zone/Land Use <b>11 Residential 1</b>			2012	73,380	116,320	10,000	179,700		
Secondary Zone			2013	73,380	116,320	10,000	179,700		
Topography			2014	73,380	116,320	10,000	179,700		
1.Level 4.Below St 7.LevelBog			2015	73,380	116,320	10,000	179,700		
2.Rolling 5.Low 8.Conform			2016	73,380	116,320	15,000	174,700		
3.Above St 6.FZone 9.Non-Confor			2017	73,380	116,320	20,000	169,700		
Utilities			2018	73,380	116,320	20,000	169,700		
1.Public 4.Dr Well 7.Cesspool			2019	73,380	116,320	20,000	169,700		
2.Water 5.Dug Well 8.			2020	73,380	116,320	25,000	164,700		
3.Sewer 6.Septic 9.None			2021	73,380	116,320	0	189,700		
Street <b>1 Paved</b>			2022	53,380	110,920	0	164,300		
1.Paved 4.Proposed 7.MHG			<b>Land Data</b>						
2.Semi Imp 5.R/O/W 8.DIS									
3.Gravel 6.MHP 9.None			<b>Front Foot</b>	<b>Type</b>	<b>Effective</b>		<b>Influence</b>		<b>Influence Codes</b>
TG PLAN YEAR <b>0</b>			11.Road Frontage		<b>Frontage</b>	<b>Depth</b>	<b>Factor</b>	<b>Code</b>	
Tif District # <b>0</b>			12.Delta Triangle				%		1.Unimproved
<b>Sale Data</b>			13.Nabla Triangle				%		2.Excess Frtg
Sale Date <b>10/20/2020</b>			14.Rear Land				%		3.Topography
Price <b>250,000</b>			15.Miscellaneous				%		4.Size/Shape
Sale Type <b>2 Land &amp; Buildings</b>							%		5.Access
1.Land 4.Mobile 7.C/I L&B							%		6.Restriction
2.L & B 5.Other 8.			<b>Square Foot</b>	<b>Square Feet</b>					7.Open Space
3.Building 6.C/I Land 9.			16.Regular Lot				%		8.View/Environ
Financing <b>9 Unknown</b>			17.Secondary Lot				%		9.Fract Share
1.Convent 4.Seller 7.			18.Hydro Facility				%		<b>Acres</b>
2.FHA/VA 5.Private 8.			19.Improvements				%		30.Rear Land 3
3.Assumed 6.Cash 9.Unknown			20.Base 3 (Fract)				%		31.Tillable
Validity <b>1 Arms Length Sale</b>							%		32.Pasture
1.Valid 4.Split 7.Renovate			<b>Fract. Acre</b>	<b>Acres/Sites</b>					33.Orchard
2.Related 5.Partial 8.Other			21.Base 1 (Fract)	24	1.00	100	%	0	34.Softwood F&O
3.Distress 6.Exempt 9.Short			22.Base 2 (Fract)	28	4.20	100	%	0	35.Mixed Wood F&O
Verified <b>5 Public Record</b>			23.Base 3	44	1.00	100	%	0	36.Hardwood F&O
1.Buyer 4.Agent 7.Family			<b>Acres</b>				%		37.Softwood TG
2.Seller 5.Pub Rec 8.Other			24.Base 1				%		38.Mixed Wood TG
3.Lender 6.MLS 9.			25.Base 2				%		39.Hardwood TG
			26.Frontage 1				%		40.Wasteland
			27.Rear Land 4				%		41.Commercial
			28.Rear Land 1				%		42.2nd Site
			29.Rear Land 2				%		43.Post Rd
			<b>Total Acreage</b>		<b>5.20</b>				44.Lot Improvemen
									45.Subdivision Lo
									46.Golf Course

**Bowdoin**

Map Lot 15-09-01

Account 1460

Location 1252 LITCHFIELD RD

Card 1 Of 1 7/22/2022

Building Style <b>3 Raised Ranch</b>	SF Bsmt Living <b>621</b>	Layout <b>1 Typical</b>
0.Not Code 4.Cape 8.Log	Fin Bsmt Grade <b>3 100</b>	1.Typical 4. 7.
1.Conv. 5.Garrison 9.Other	OCCUPANCY <b>0</b>	2.Inadeq 5. 8.
2.Ranch 6.Split 10.DW	Heat Type <b>100% 1 Hot Water BB</b>	3.Poor 6. 9.
3.R Ranch 7.Contemp 11.Church	0.Not Code 4.Steam 8.FI/Wall	Attic <b>9 None</b>
Dwelling Units <b>1</b>	1.HWBB 5.FWA 9.No Heat	1.1/4 Fin 4.Full Fin 7.
Other Units <b>0</b>	2.HWCI 6.GravWA 11.	2.1/2 Fin 5.FI/Stair 8.
Stories <b>1 One Story</b>	3.H Pump 7.Electric 12.	3.3/4 Fin 6. 9.None
1.1 4.1.5 7.4	Cool Type <b>0% 9 None</b>	Insulation <b>1 Full</b>
2.2 5.1.75 8.20	1.Refrig 4.W&C Air 7.	1.Full 4.Minimal 7.
3.3 6.2.5 9.Yurt	2.Evapor 5. 8.	2.Heavy 5. 8.
Exterior Walls <b>2 Vinyl/Aluminum</b>	3.H Pump 6. 9.None	3.Capped 6. 9.None
0.Not Code 4.Asbestos 8.Concrete	Kitchen Style <b>2 Typical</b>	Unfinished % <b>0%</b>
1.Wood 5.Stucco 9.Other	1.Modern 4.Obsolete 7.	Grade & Factor <b>3 Average 100%</b>
2.Vin/Al 6.Brick 10.Board B	2.Typical 5. 8.	1.E Grade 4.B Grade 7.
3.Compos. 7.Stone 12.	3.Old Type 6. 9.None	2.D Grade 5.A Grade 8.
Roof Surface <b>1 Asphalt Shingles</b>	Bath(s) Style <b>2 Typical Bath(s)</b>	3.C Grade 6.AA Grade 9.Same
1.Asphalt 4.Composit 7.	1.Modern 4.Obsolete 7.	SQFT (Footprint) <b>828</b>
2.Slate 5.Wood 8.	2.Typical 5. 8.	Condition <b>4 Average</b>
3.Metal 6.Other 9.	3.Old Type 6. 9.None	1.Poor 4.Avg 7.V G
SF Masonry Trim <b>0</b>	# Rooms <b>9</b>	2.Fair 5.Avg+ 8.Exc
SEPTIC DESIGN <b>0</b>	# Bedrooms <b>2</b>	3.Avg- 6.Good 9.Same
BLDG PERMIT <b>0</b>	# Full Baths <b>2</b>	Phys. % Good <b>0%</b>
Year Built <b>1992</b>	# Half Baths <b>1</b>	Funct. % Good <b>100%</b>
Year Remodeled <b>0</b>	# Addn Fixtures <b>0</b>	Functional Code <b>9 None</b>
Foundation <b>1 Concrete</b>	# Fireplaces <b>0</b>	1.Incomp 4.Delap 7.No Power
1.Concrete 4.Wood 7.	 <p><b>TRIO</b> Software A Division of Harris Computer Systems</p>	2.O-Built 5.Bsmt 8.LongTerm
2.C Block 5.Slab 8.		3.Damage 6.Dbwd 9.None
3.Br/Stone 6.Piers 9.		Econ. % Good <b>100%</b>
Basement <b>4 Full Basement</b>		Economic Code <b>None</b>
1.1/4 Bmt 4.Full Bmt 7.		0.None 3.No Power 7.
2.1/2 Bmt 5.None 8.		1.Location 4.Generate 8.
3.3/4 Bmt 6. 9.None		2.Encroach 9.None 9.
Bsmt Gar # Cars <b>0</b>		Entrance Code <b>3 Information Only</b>
Wet Basement <b>1 Dry Basement</b>		1.Interior 4.Vacant 7.Entered
1.Dry 4. 7.		2.Refusal 5.Estimate 8.No
2.Damp 5. 8.	3.Informed 6.Reviewed 9.Land	
3.Wet 6. 9.	Information Code <b>1 Owner</b>	
		1.Owner 4.Agent 7.
		2.Relative 5.Estimate 8.
		3.Tenant 6.Other 9.

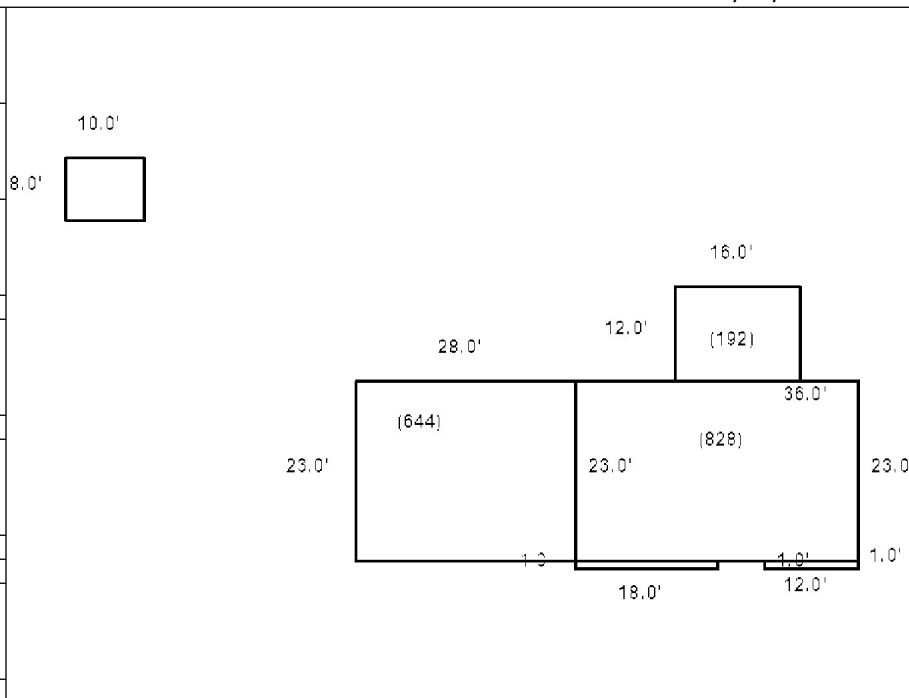

Date Inspected

**Additions, Outbuildings & Improvements**

Type	Year	Units	Grade	Cond	Phys.	Funct.	Sound Value
23 Attached Garage	0	644	0 0	0	0 %	0 %	
24 Frame Shed	0				%	%	200
26 1SFr Overhang	0	18	0 0	0	0 %	0 %	
26 1SFr Overhang	0	12	0 0	0	0 %	0 %	
68 Wood Deck	0	192	0 0	0	0 %	0 %	
					%	%	
					%	%	
					%	%	
					%	%	
					%	%	
					%	%	

- 1.One Story Fram
- 2.Two Story Fram
- 3.Three Story Fr
- 4.1 & 1/2 Story
- 5.1 & 3/4 Story
- 6.2 & 1/2 Story
- 21.Open Frame Por
- 22.Encl Frame Por
- 23.Attached Garag
- 24.Frame Shed
- 25.Frame Bay Wind
- 26.1SFr Overhang
- 27.Unfin Basement
- 28.Unfinished Att
- 29.Finished Attic

STAPLES, STEPHANIE D  
STAPLES, WINTHROP C JR  
1256 LITCHFIELD RD  
BOWDOIN ME 04287

B1877P336 B3273P202 B2016RP2790

Previous Owner  
BEHR, LINDA F  
HALLOWELL, THOMAS W  
1256 LITCHFIELD RD  
BOWDOIN ME 04287  
Sale Date: 4/29/2016

Previous Owner  
PULK, MICHAEL E  
PULK, JENNIFER M  
150 HILLTOP DR  
BAYFIELD CO 81122  
Sale Date: 2/23/2011

Inspection Witnessed By:

X	Date
No./Date	Description
	Date Insp.

Notes:

**Bowdoin**

Property Data			Assessment Record						
Neighborhood <b>15 Map 15</b>			Year	Land	Buildings	Exempt	Total		
Tree Growth Year <b>0</b>			2009	57,300	77,620	0	134,920		
Farmland Yr <b>0</b>			2010	57,300	77,620	0	134,920		
Open Space Yr <b>0</b>			2011	57,300	77,620	0	134,920		
Zone/Land Use <b>11 Residential 1</b>			2012	57,300	77,620	10,000	124,920		
Secondary Zone			2013	57,300	95,890	10,000	143,190		
Topography			2014	57,300	95,890	10,000	143,190		
1.Level 4.Below St 7.LevelBog			2015	57,300	95,890	10,000	143,190		
2.Rolling 5.Low 8.Conform			2016	57,300	95,890	15,000	138,190		
3.Above St 6.FZone 9.Non-Confor			2017	57,300	95,890	0	153,190		
Utilities			2018	57,300	95,890	0	153,190		
1.Public 4.Dr Well 7.Cesspool			2019	57,300	95,890	0	153,190		
2.Water 5.Dug Well 8.			2020	57,300	95,890	0	153,190		
3.Sewer 6.Septic 9.None			2021	57,300	95,890	0	153,190		
Street <b>1 Paved</b>			2022	57,300	89,020	0	146,320		
1.Paved 4.Proposed 7.MHG			<b>Land Data</b>						
2.Semi Imp 5.R/O/W 8.DIS			<b>Front Foot</b>	<b>Type</b>	<b>Effective</b>		<b>Influence</b>		<b>Influence Codes</b>
3.Gravel 6.MHP 9.None					Frontage	Depth	Factor	Code	
TG PLAN YEAR <b>0</b>			11.Road Frontage					1.Unimproved	
Tif District # <b>0</b>			12.Delta Triangle					2.Excess Frtg	
<b>Sale Data</b>			13.Nabla Triangle					3.Topography	
Sale Date <b>4/29/2016</b>			14.Rear Land					4.Size/Shape	
Price <b>182,000</b>			15.Miscellaneous					5.Access	
Sale Type <b>2 Land &amp; Buildings</b>								6.Restriction	
1.Land 4.Mobile 7.C/I L&B								7.Open Space	
2.L & B 5.Other 8.			<b>Square Foot</b>	<b>Square Feet</b>				8.View/Environ	
3.Building 6.C/I Land 9.			16.Regular Lot					9.Fract Share	
Financing <b>9 Unknown</b>			17.Secondary Lot					<b>Acres</b>	
1.Convent 4.Seller 7.			18.Hydro Facility					30.Rear Land 3	
2.FHA/VA 5.Private 8.			19.Improvements					31.Tillable	
3.Assumed 6.Cash 9.Unknown			20.Base 3 (Fract)					32.Pasture	
Validity <b>1 Arms Length Sale</b>								33.Orchard	
1.Valid 4.Split 7.Renovate			<b>Fract. Acre</b>	<b>Acres/Sites</b>				34.Softwood F&O	
2.Related 5.Partial 8.Other			21.Base 1 (Fract)	24	1.00	100	%	0	
3.Distress 6.Exempt 9.Short			22.Base 2 (Fract)	28	7.00	100	%	0	
Verified <b>5 Public Record</b>			23.Base 3	44	1.00	100	%	0	
1.Buyer 4.Agent 7.Family			<b>Acres</b>						
2.Seller 5.Pub Rec 8.Other			24.Base 1						
3.Lender 6.MLS 9.			25.Base 2						
			26.Frontage 1						
			27.Rear Land 4						
			28.Rear Land 1						
			29.Rear Land 2						
			<b>Total Acreage</b>		8.00				
								44.Lot Improvemen	
								45.Subdivision Lo	
								46.Golf Course	

**Bowdoin**

Map Lot 15-09-02

Account 1461

Location 1256 LITCHFIELD RD

Card 1

Of 1

7/22/2022

Building Style <b>8 Log Home</b>	SF Bsmt Living <b>0</b>	Layout <b>1 Typical</b>
0.Not Code 4.Cape 8.Log	Fin Bsmt Grade <b>0 0</b>	1.Typical 4. 7.
1.Conv. 5.Garrison 9.Other	OCCUPANCY <b>0</b>	2.Inadeq 5. 8.
2.Ranch 6.Split 10.DW	Heat Type <b>100% 5 Forced Warm Air</b>	3.Poor 6. 9.
3.R Ranch 7.Contemp 11.Church	0.Not Code 4.Steam 8.FI/Wall	Attic <b>9 None</b>
Dwelling Units <b>1</b>	1.HWBB 5.FWA 9.No Heat	1.1/4 Fin 4.Full Fin 7.
Other Units <b>0</b>	2.HWCI 6.GravWA 11.	2.1/2 Fin 5.FI/Stair 8.
Stories <b>1 One Story</b>	3.H Pump 7.Electric 12.	3.3/4 Fin 6. 9.None
1.1 4.1.5 7.4	Cool Type <b>0% 9 None</b>	Insulation <b>1 Full</b>
2.2 5.1.75 8.20	1.Refrig 4.W&C Air 7.	1.Full 4.Minimal 7.
3.3 6.2.5 9.Yurt	2.Evapor 5. 8.	2.Heavy 5. 8.
Exterior Walls <b>1 Wood Siding</b>	3.H Pump 6. 9.None	3.Capped 6. 9.None
0.Not Code 4.Asbestos 8.Concrete	Kitchen Style <b>2 Typical</b>	Unfinished % <b>0%</b>
1.Wood 5.Stucco 9.Other	1.Modern 4.Obsolete 7.	Grade & Factor <b>3 Average 100%</b>
2.Vin/Al 6.Brick 10.Board B	2.Typical 5. 8.	1.E Grade 4.B Grade 7.
3.Compos. 7.Stone 12.	3.Old Type 6. 9.None	2.D Grade 5.A Grade 8.
Roof Surface <b>1 Asphalt Shingles</b>	Bath(s) Style <b>2 Typical Bath(s)</b>	3.C Grade 6.AA Grade 9.Same
1.Asphalt 4.Composit 7.	1.Modern 4.Obsolete 7.	SQFT (Footprint) <b>912</b>
2.Slate 5.Wood 8.	2.Typical 5. 8.	Condition <b>3 Below Average</b>
3.Metal 6.Other 9.	3.Old Type 6. 9.None	1.Poor 4.Avg 7.V G
SF Masonry Trim <b>0</b>	# Rooms <b>6</b>	2.Fair 5.Avg+ 8.Exc
SEPTIC DESIGN <b>0</b>	# Bedrooms <b>2</b>	3.Avg- 6.Good 9.Same
BLDG PERMIT <b>0</b>	# Full Baths <b>1</b>	Phys. % Good <b>0%</b>
Year Built <b>1986</b>	# Half Baths <b>0</b>	Funct. % Good <b>100%</b>
Year Remodeled <b>0</b>	# Addn Fixtures <b>0</b>	Functional Code <b>9 None</b>
Foundation <b>1 Concrete</b>	# Fireplaces <b>0</b>	1.Incomp 4.Delap 7.No Power
1.Concrete 4.Wood 7.		2.O-Built 5.Bsmt 8.LongTerm
2.C Block 5.Slab 8.		3.Damage 6.Dbwd 9.None
3.Br/Stone 6.Piers 9.		Econ. % Good <b>100%</b>
Basement <b>4 Full Basement</b>		Economic Code <b>None</b>
1.1/4 Bmt 4.Full Bmt 7.		0.None 3.No Power 7.
2.1/2 Bmt 5.None 8.		1.Location 4.Generate 8.
3.3/4 Bmt 6. 9.None		2.Encroach 9.None 9.
Bsmt Gar # Cars <b>0</b>		Entrance Code <b>5 Estimated</b>
Wet Basement <b>0</b>		1.Interior 4.Vacant 7.Entered
1.Dry 4. 7.		2.Refusal 5.Estimate 8.No
2.Damp 5. 8.	3.Informed 6.Reviewed 9.Land	
3.Wet 6. 9.	Information Code <b>5 Estimate</b>	
	1.Owner 4.Agent 7.	
	2.Relative 5.Estimate 8.	
	3.Tenant 6.Other 9.	

Date Inspected 4/18/2013

**Additions, Outbuildings & Improvements**

Type	Year	Units	Grade	Cond	Phys.	Funct.	Sound Value
21 Open Frame	0	208	0 0	0	0 %	0 %	
24 Frame Shed	0	160	0 0	0	0 %	0 %	
30 Detached Garage	2012	672	3 100	3	0 %	100 %	
					%	%	
					%	%	
					%	%	
					%	%	
					%	%	
					%	%	
					%	%	
					%	%	
					%	%	

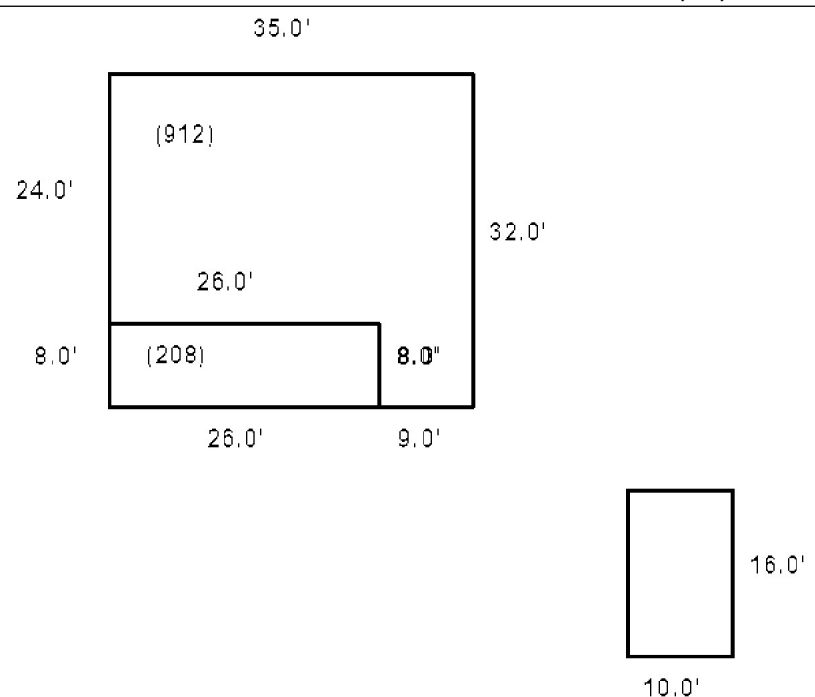



**Bowdoin**

Map Lot 15-10-0

Account 1462

Location LITCHFIELD RD

Card 1 Of 1 7/22/2022

Building Style <b>0 Not Coded</b>	SF Bsmt Living <b>0</b>	Layout <b>0</b>
0.Not Code 4.Cape 8.Log	Fin Bsmt Grade <b>0 0</b>	1.Typical 4. 7.
1.Conv. 5.Garrison 9.Other	OCCUPANCY <b>0</b>	2.Inadeq 5. 8.
2.Ranch 6.Split 10.DW	Heat Type <b>100% 0 Not Coded</b>	3.Poor 6. 9.
3.R Ranch 7.Contemp 11.Church	0.Not Code 4.Steam 8.FI/Wall	Attic <b>0</b>
Dwelling Units <b>0</b>	1.HWBB 5.FWA 9.No Heat	1.1/4 Fin 4.Full Fin 7.
Other Units <b>0</b>	2.HWCI 6.GravWA 11.	2.1/2 Fin 5.FI/Stair 8.
Stories <b>0</b>	3.H Pump 7.Electric 12.	3.3/4 Fin 6. 9.None
1.1 4.1.5 7.4	Cool Type <b>0% 9 None</b>	Insulation <b>0</b>
2.2 5.1.75 8.20	1.Refrig 4.W&C Air 7.	1.Full 4.Minimal 7.
3.3 6.2.5 9.Yurt	2.Evapor 5. 8.	2.Heavy 5. 8.
Exterior Walls <b>0 Not Coded</b>	3.H Pump 6. 9.None	3.Capped 6. 9.None
0.Not Code 4.Asbestos 8.Concrete	Kitchen Style <b>0</b>	Unfinished % <b>0%</b>
1.Wood 5.Stucco 9.Other	1.Modern 4.Obsolete 7.	Grade & Factor <b>0 0%</b>
2.Vin/Al 6.Brick 10.Board B	2.Typical 5. 8.	1.E Grade 4.B Grade 7.
3.Compos. 7.Stone 12.	3.Old Type 6. 9.None	2.D Grade 5.A Grade 8.
Roof Surface <b>0</b>	Bath(s) Style <b>0</b>	3.C Grade 6.AA Grade 9.Same
1.Asphalt 4.Composit 7.	1.Modern 4.Obsolete 7.	SQFT (Footprint) <b>0</b>
2.Slate 5.Wood 8.	2.Typical 5. 8.	Condition <b>0</b>
3.Metal 6.Other 9.	3.Old Type 6. 9.None	1.Poor 4.Avg 7.V G
SF Masonry Trim <b>0</b>	# Rooms <b>0</b>	2.Fair 5.Avg+ 8.Exc
SEPTIC DESIGN <b>0</b>	# Bedrooms <b>0</b>	3.Avg- 6.Good 9.Same
BLDG PERMIT <b>0</b>	# Full Baths <b>0</b>	Phys. % Good <b>0%</b>
Year Built <b>0</b>	# Half Baths <b>0</b>	Funct. % Good <b>100%</b>
Year Remodeled <b>0</b>	# Addn Fixtures <b>0</b>	Functional Code <b>9 None</b>
Foundation <b>0</b>	# Fireplaces <b>0</b>	1.Incomp 4.Delap 7.No Power
1.Concrete 4.Wood 7.		2.O-Built 5.Bsmt 8.LongTerm
2.C Block 5.Slab 8.		3.Damage 6.Dbwd 9.None
3.Br/Stone 6.Piers 9.		Econ. % Good <b>100%</b>
Basement <b>0</b>		Economic Code <b>None</b>
1.1/4 Bmt 4.Full Bmt 7.		0.None 3.No Power 7.
2.1/2 Bmt 5.None 8.		1.Location 4.Generate 8.
3.3/4 Bmt 6. 9.None		2.Encroach 9.None 9.
Bsmt Gar # Cars <b>0</b>		Entrance Code <b>0</b>
Wet Basement <b>0</b>		1.Interior 4.Vacant 7.Entered
1.Dry 4. 7.		2.Refusal 5.Estimate 8.No
2.Damp 5. 8.	3.Informed 6.Reviewed 9.Land	
3.Wet 6. 9.	Information Code <b>0</b>	
	1.Owner 4.Agent 7.	
	2.Relative 5.Estimate 8.	
	3.Tenant 6.Other 9.	

Date Inspected

Additions, Outbuildings & Improvements							
Type	Year	Units	Grade	Cond	Phys.	Funct.	Sound Value
					%	%	1.One Story Fram
					%	%	2.Two Story Fram
					%	%	3.Three Story Fr
					%	%	4.1 & 1/2 Story
					%	%	5.1 & 3/4 Story
					%	%	6.2 & 1/2 Story
					%	%	21.Open Frame Por
					%	%	22.Encl Frame Por
					%	%	23.Attached Garag
					%	%	24.Frame Shed
					%	%	25.Frame Bay Wind
					%	%	26.1SFr Overhang
					%	%	27.Unfin Basement
					%	%	28.Unfinished Att
					%	%	29.Finished Attic